

DESIGNCOVER CXBE 1.1

Assembly instruction

As at 03.07.2019



Designcover left

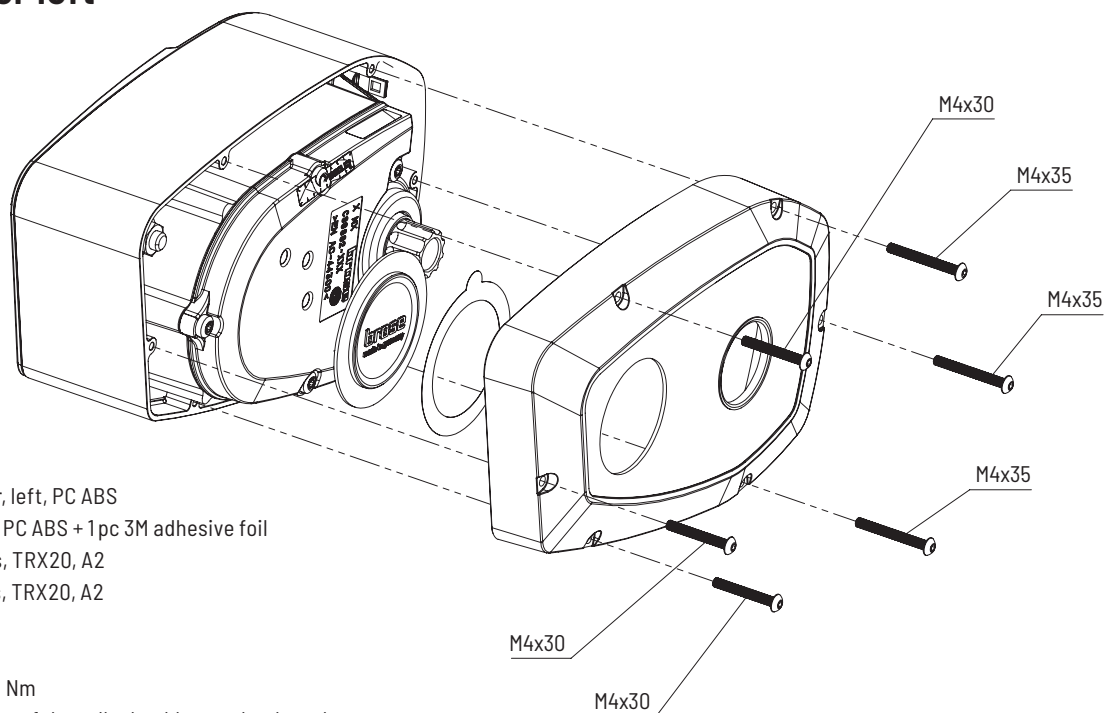

Parts included

- * 1 pc CXBE 1.1 cover, left, PC ABS
- * 1 pc Brose button, PC ABS + 1 pc 3M adhesive foil
- * 3 pcs M4x30 bolts, TRX20, A2
- * 3 pcs M4x35 bolts, TRX20, A2

Note

- * Tightning torque 1 Nm
- * Apply several drops of threadlocker blue on the threads
- * The Brose button must get aligned horizontally (Brose CI)
- * Compatible with Brose Drive Alu

Designcover right

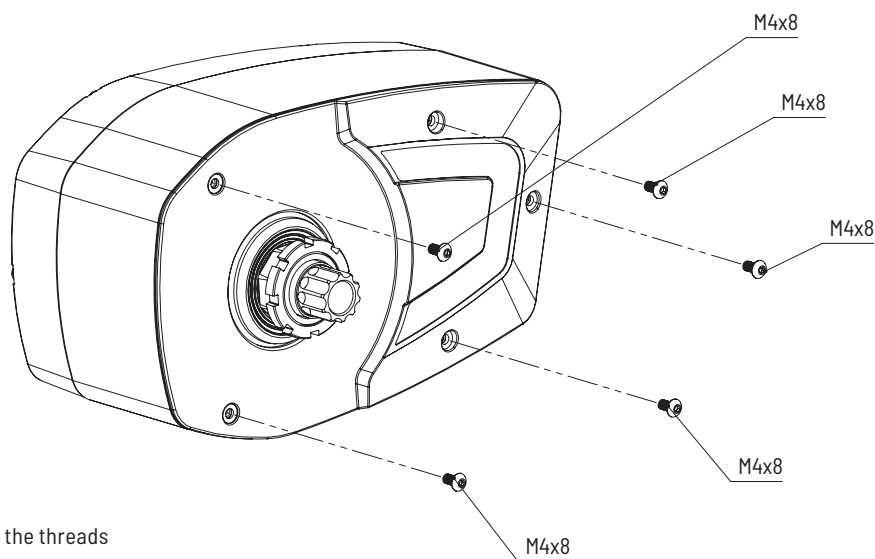

Parts included

- * 1 pc CXBE 1.0 cover, right, PC ABS
- * 6 pcs M4x8 bolts, TRX20, A2

Note

- * Tightning torque 1 Nm
- * Apply several drops of threadlocker blue on the threads
- * Compatible with Brose Drive Alu